

Turnkey

Brewery Plants

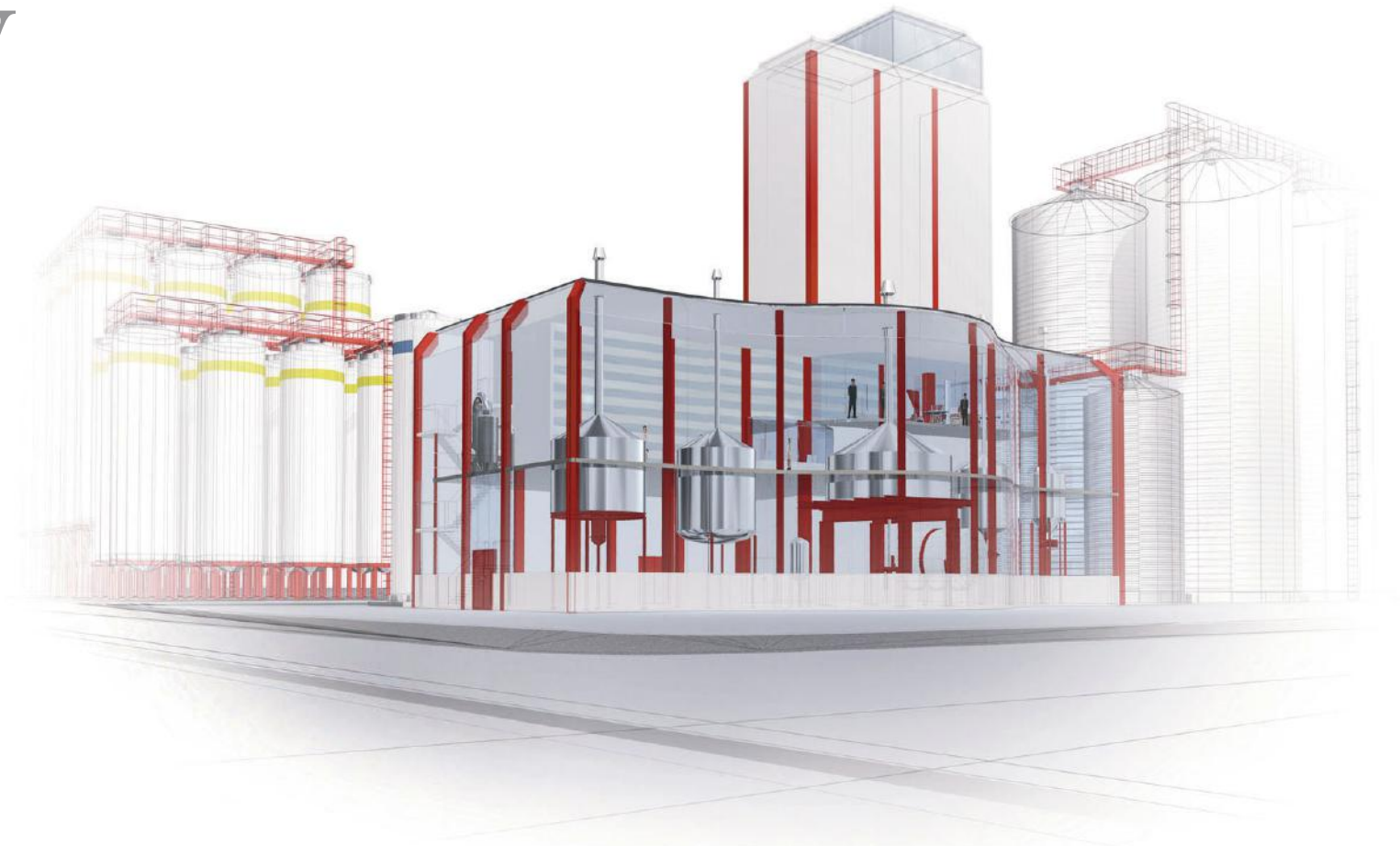

4 Steps to a complete brewery – our all-round care-free package for your profitable investment

The advantages:

- Complete brewery from one source
- Extensive competence
- Smooth interfaces
- Fast communication
- ~~Flexible decisions~~
- Own research and development
- Decades of experience with brewing plants all over the world
- First-class service

1 Feasibility Study: Who is producing which beer and for whom?

The first step to a turnkey brewery: What is feasible? With our feasibility study we reveal all options within the scope of your specified requirements: beer types, recipes, volumes, engineering, product design in the Ziemann Holvrieka ~~Technology Center~~, marketing consultation services.



Detailed preparation work: Thorough research, wellfounded information, clear-cut perspectives.

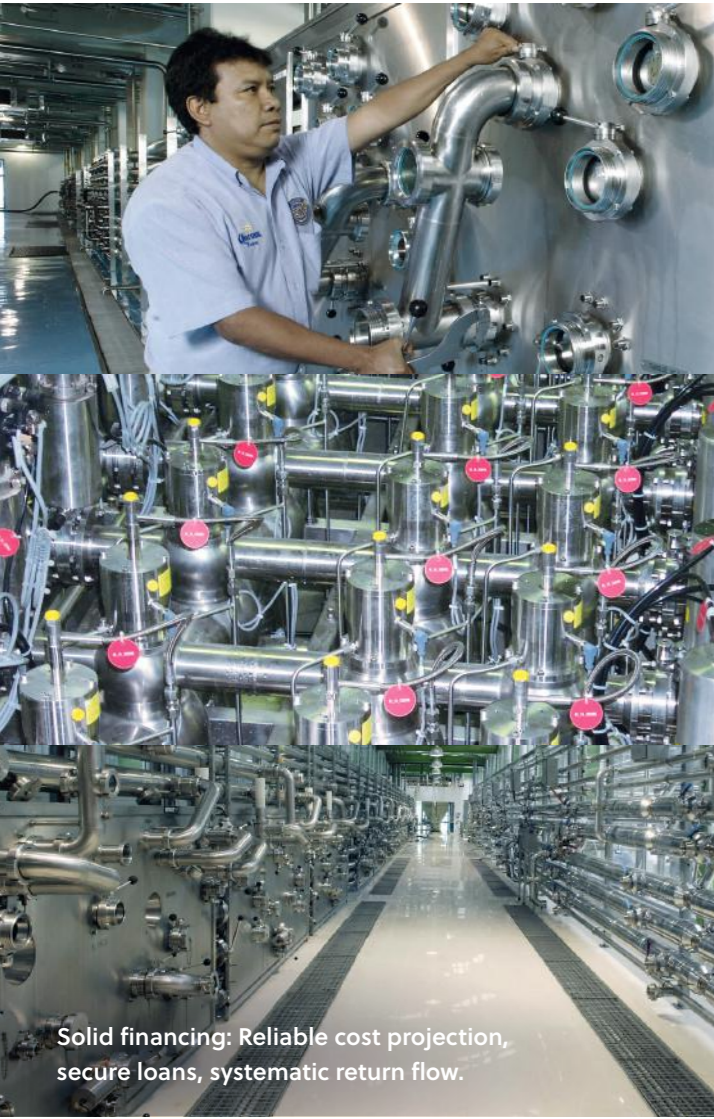

2 Financial Planning: What investments are required?

The second step to a turnkey brewery: Where are the funds coming from? Ziemann Holvrieka assists you in the organization of a solid financing and audits the costs in each stage. Plan: speedy return of the investment.

Solid financing: Reliable cost projection, secure loans, systematic return flow.

3 Engineering and Design: Which type of machinery and under which roof?

The third step to a turnkey brewery: What equipment is really needed? Exact planning of the production plant down to the last detail. Each vessel, each door and each transport route can be viewed in 3-D imaging by means of CAD. P&I diagrams describe the applied techniques and technology. Foreseeable market developments and expansion phases are also taken into account.



Exact planning: The most efficient plants, state-of-the-art technology, visualization using CAD.

4 Implementation: When will beer start to flow?

The fourth step to a turnkey brewery: implementation within cost and schedule estimate. With all technical and technological innovations including automation. Accomplishment of all guaranteed values. Training of personnel on the spot or at the Ziemann Holvrieka **Technology Center**. Start-up and handing over of the plant. Technical and technological service.



Perfect implementation: Maximum high-tech quality, economical operation, minimum emissions, perfect product.





To find out more visit
ziemann-holvrieka.com/contact